

hi-spec SUPPLIES



ALUMINIUM BI-FOLDING DOOR SYSTEM

hi-spec SUPPLIES



ALUMINIUM BI-FOLDING DOOR SYSTEM

BI-FOLDING DOOR SPECIFICATION

FRAME	73MM
SASH	73MM
FRAME / SASH	121MM
SASH /SASH	120MM
MAXIMUM GLAZING	45MM
MAXIMUM WEIGHT PER SASH	120KG
MAXIMUM SASH HEIGHT	3000MM
MAXIMUM SASH WIDTH	1200MM
*AIR PERMEABILITY	CLASS 4
*WATER TIGHTNESS	CLASS 9A
*WIND RESISTANCE	CLASS A3

*Reference test 2,70 x 2,53 m, 3 sashes

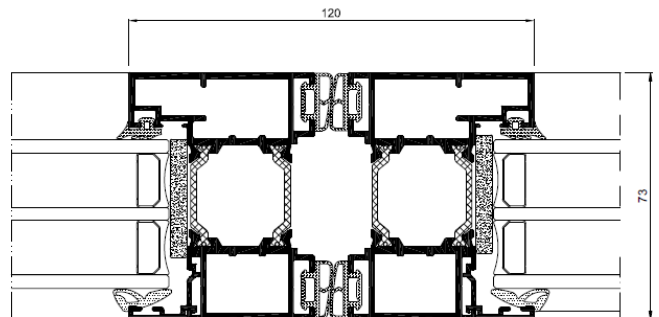
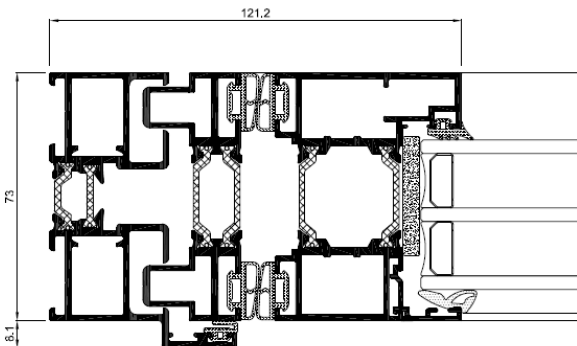

BI-FOLDING DOOR SPECIFICATION

FRAME / SASH

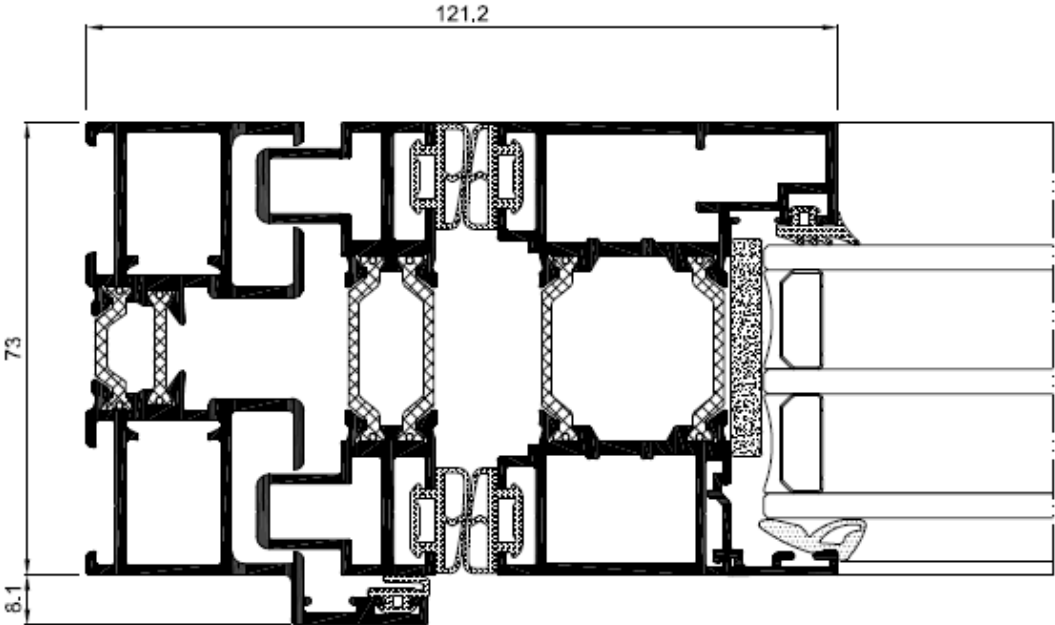

SASH / SASH

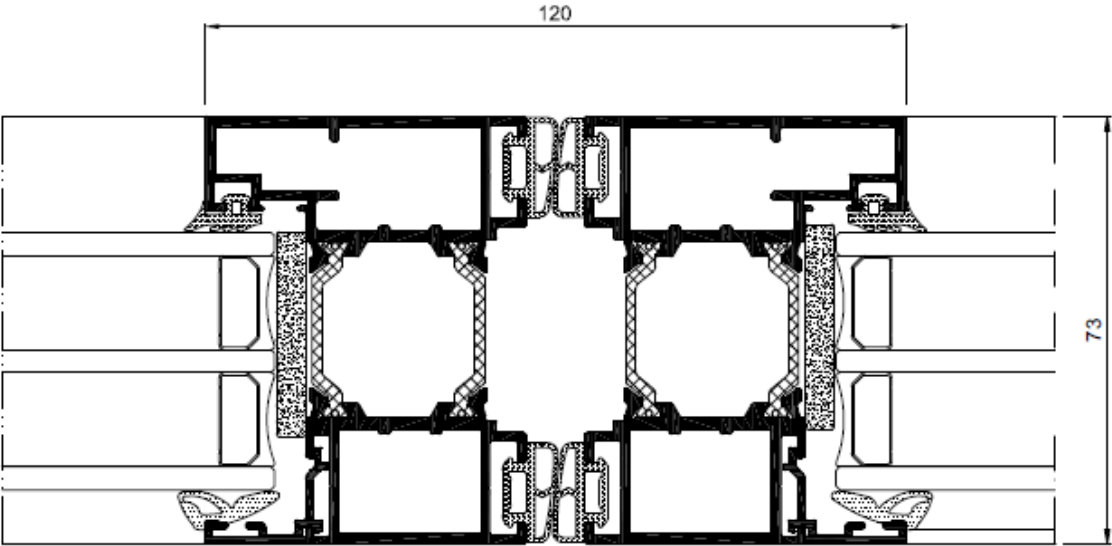

BI-FOLDING DOOR SPECIFICATION

150MM CILL

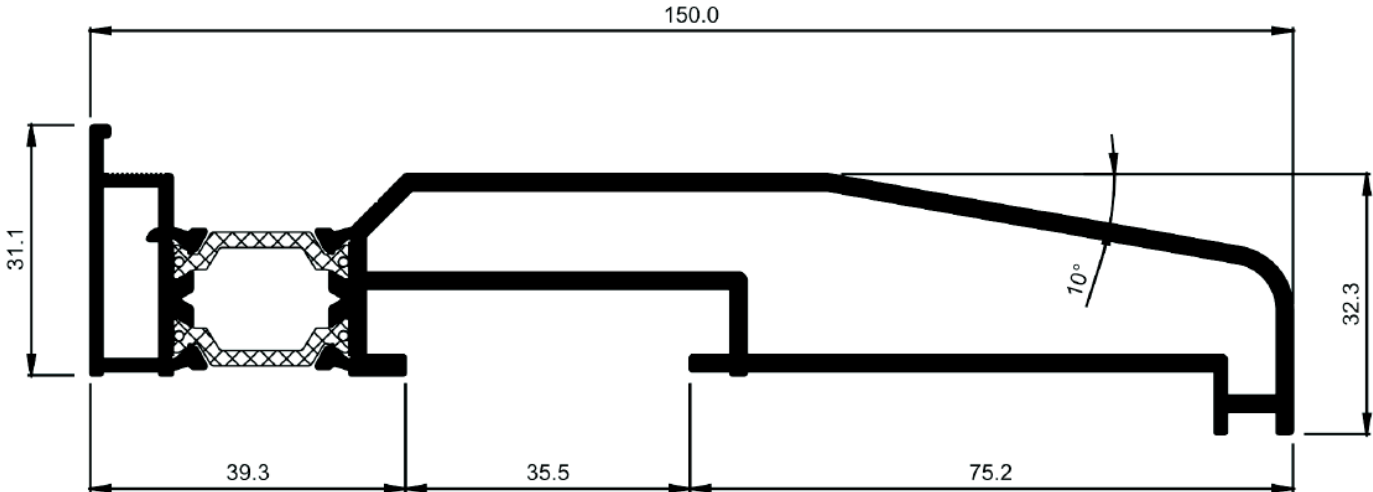

LOW THRESHOLD / RAMP

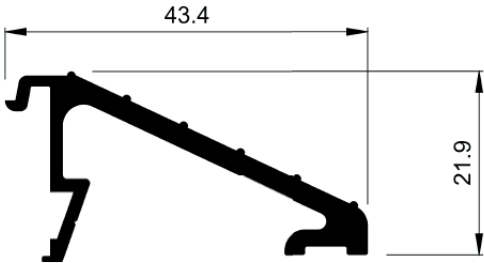
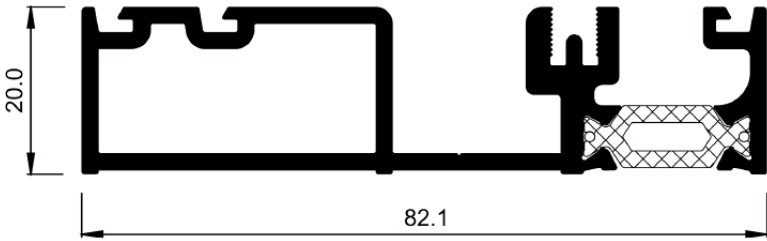

BI-FOLDING DOOR SPECIFICATION

SASH, FRAMES AND 150 CILL

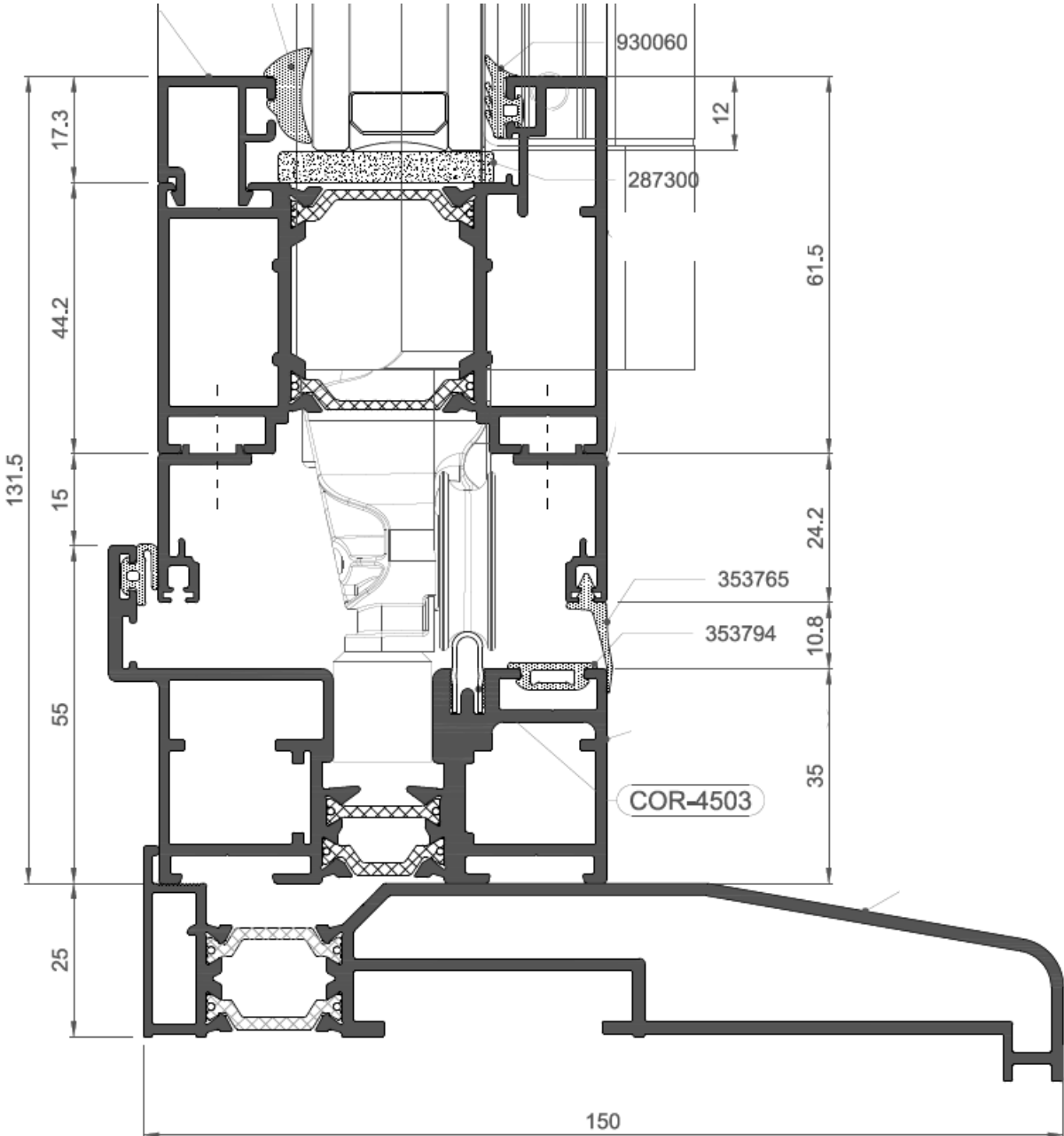

BI-FOLDING DOOR SPECIFICATION

SASH, FRAMES AND LOW THRESHOLD TRIM/RAMP

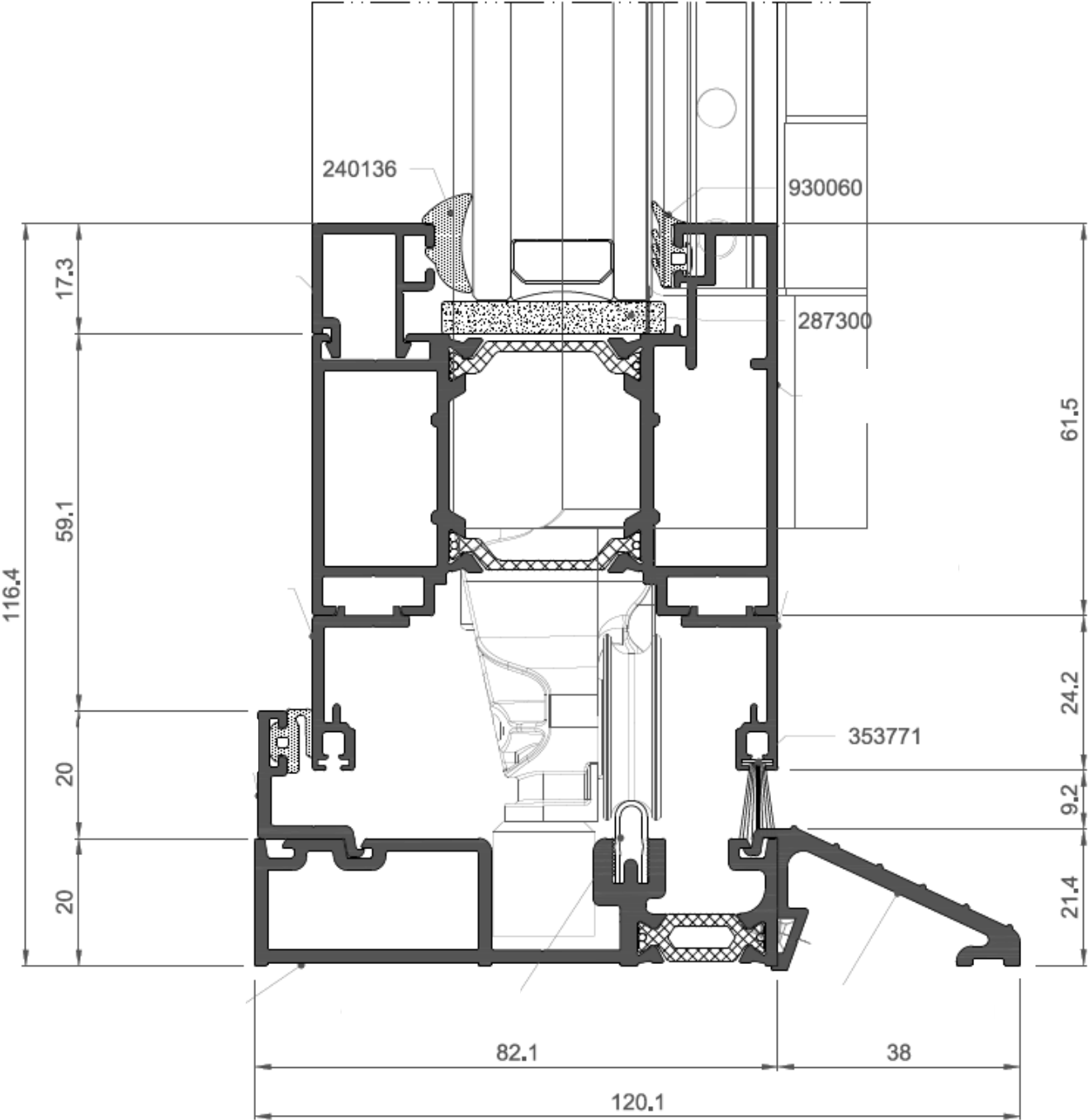

BI-FOLDING DOOR SPECIFICATION

SASH,FRAMES AND LOW THRESHOLD RAMP/RAMP

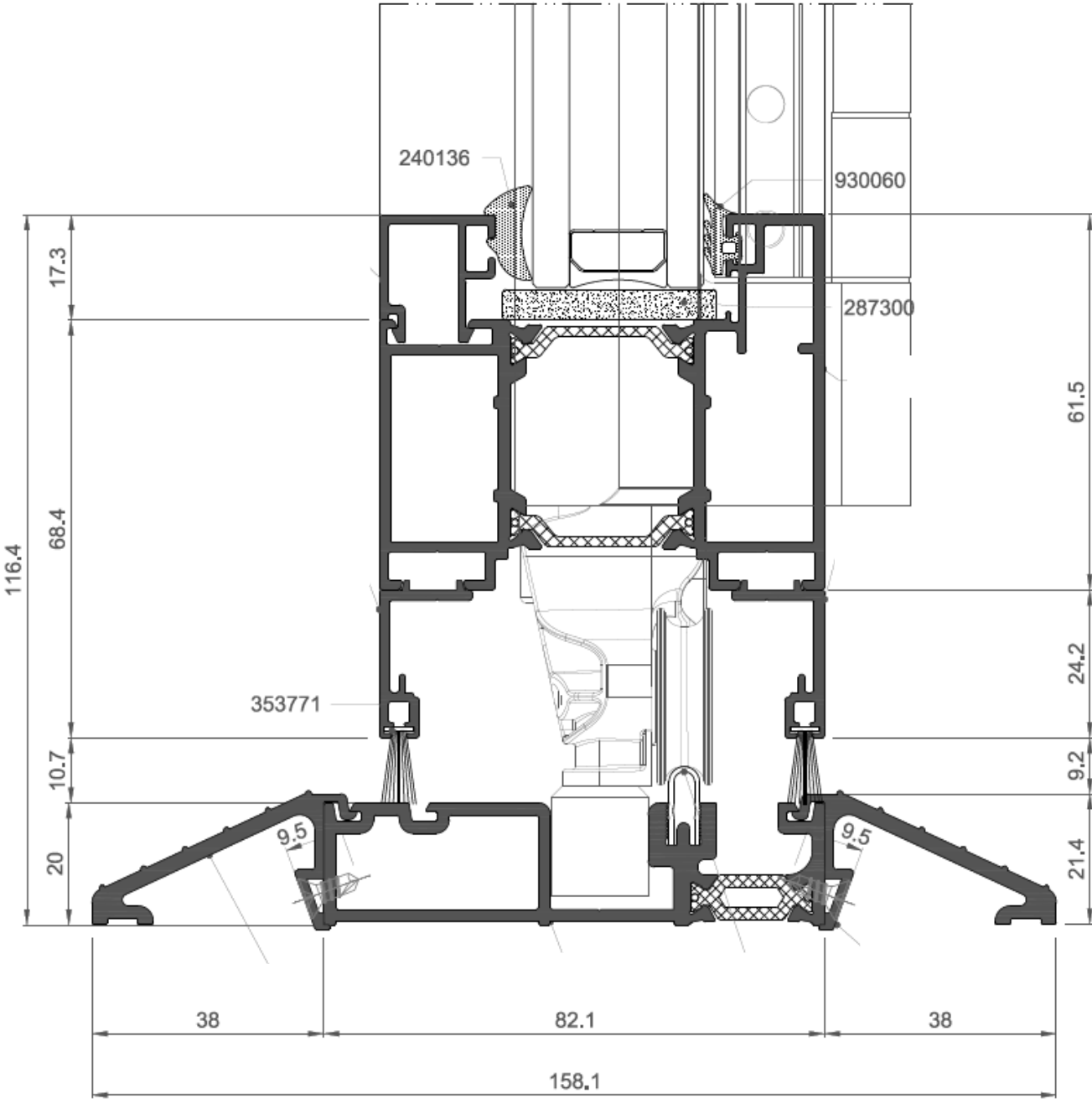

BI-FOLDING DOOR SPECIFICATION

INTEGRATED CILL

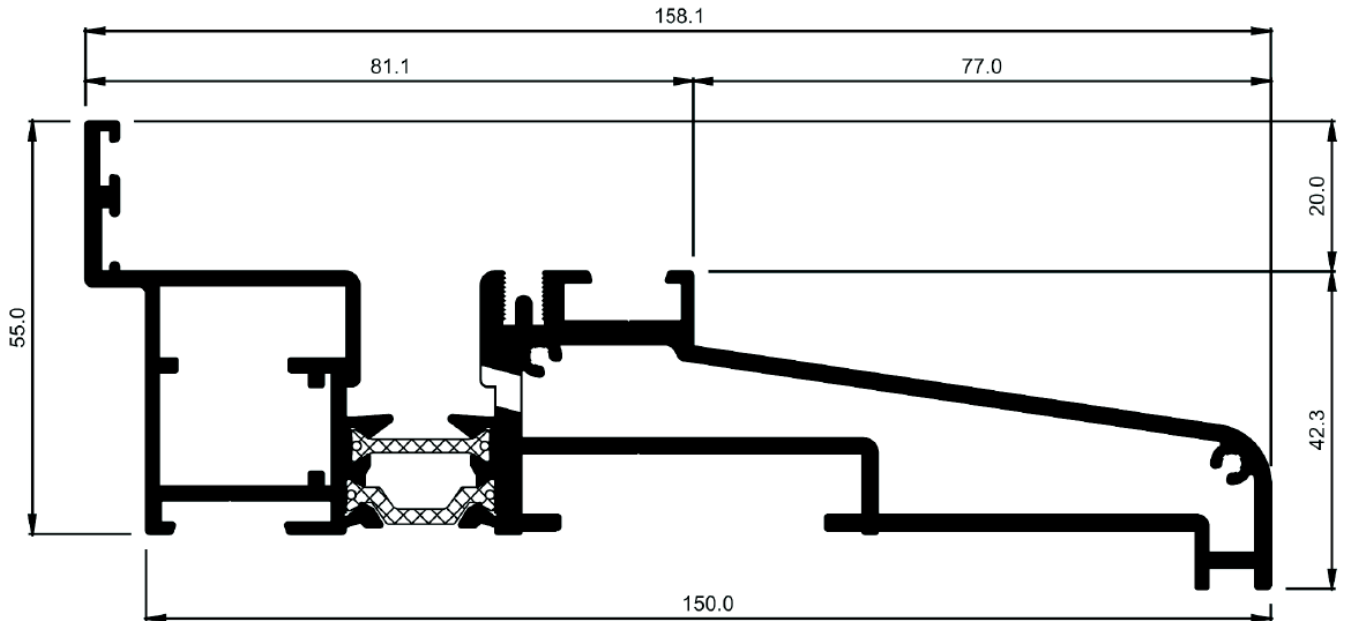

INGENIOUS DUPLEX LOCK AND APECS AP CYLINDER

£5,000 GUARANTEE

By upgrading to the APECS AP and DUPLEX lock, this will enable you to offer your end user customer the peace of mind guarantee. To apply, the end user would need to directly register the installation on the APECS/DUPLEX lock portal for it to be activated. This will allow them to be covered with the break in guarantee.

T/C apply please see website:



hi-spec
SUPPLIES

ALUMINIUM BI-FOLDING DOOR SYSTEM

BI-FOLDING DOOR SPECIFICATION

BI-FOLD DOOR COLOUR OPTIONS



STANDARD COLOURS (both sides)

- WHITE
- BLACK
- ANTHRACITE GREY

DUAL COLOURS (available on request)

ANY RAL COLOURS (available on request)

WOODGRAIN COLOURS (both sides)

- ROSEWOOD
- IRISH OAK
- LIGHT OAK



hi-spec SUPPLIES

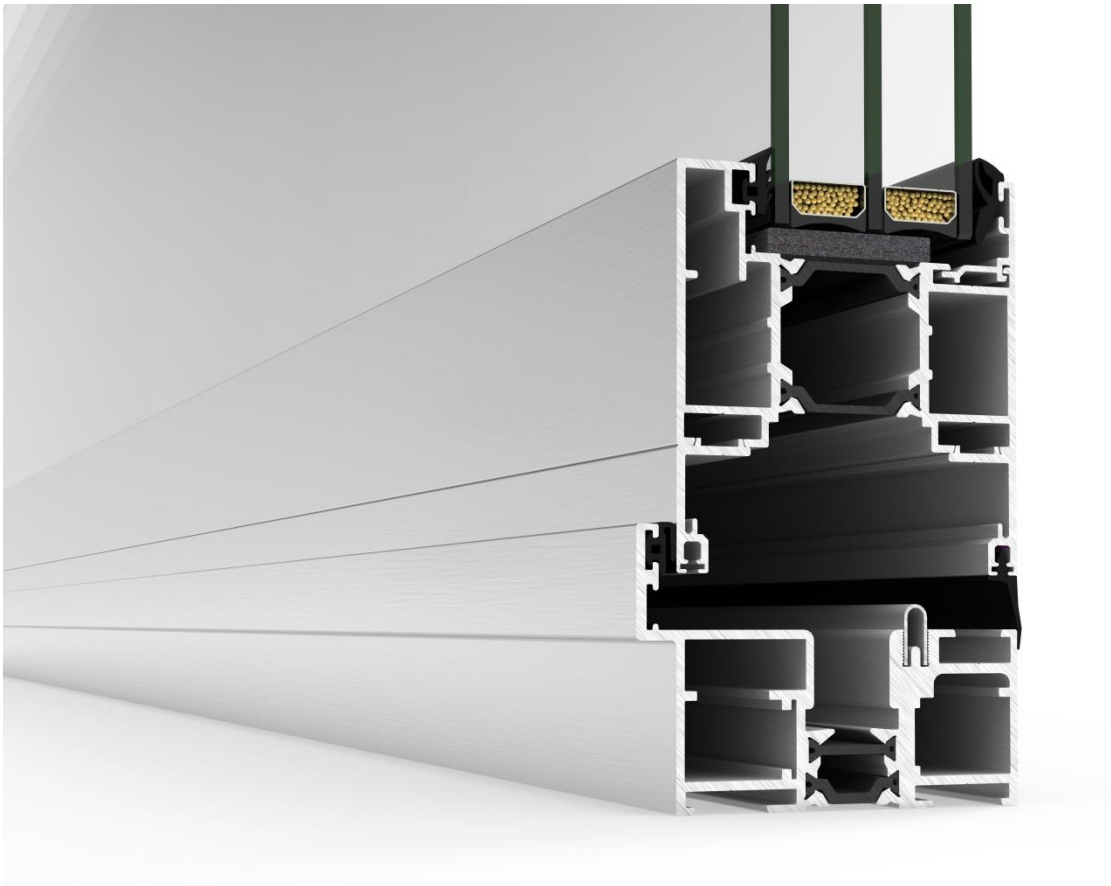

ALUMINIUM BI-FOLDING DOOR SYSTEM